

## 04 PERSON COASTAL LIFERAFT - USCG GRP LOW PROFILE CONTAINER & VALISE

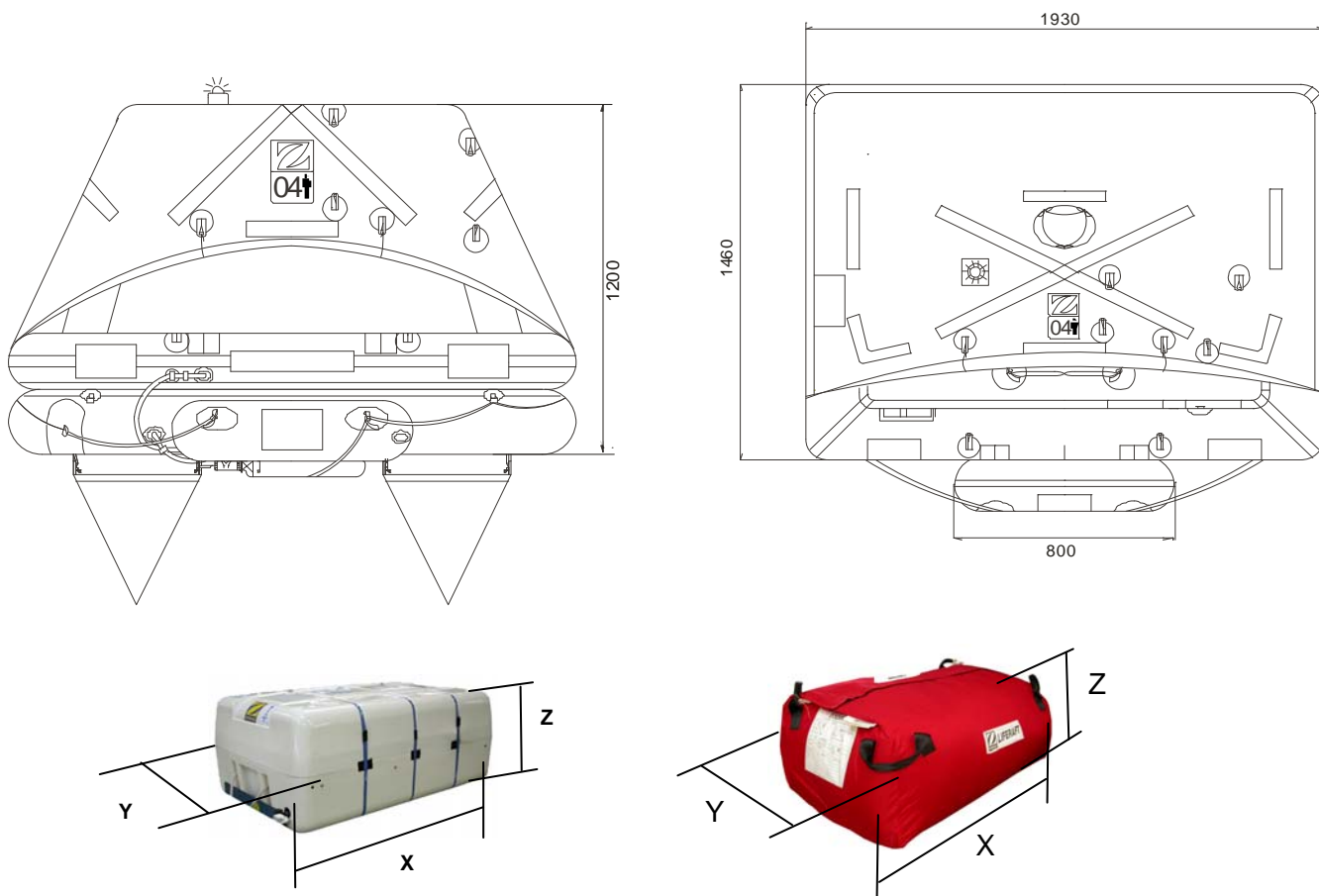
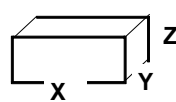

4 MAN	GRP container			Valise		
<b>Container</b>	<b>N131</b>			<b>N° 3</b>		
Dimensions	X: 800 mm	Y: 518 mm	Z: 300 mm	X: 690 mm	Y: 250 mm	Z: 300 mm
	X: 2' 7,5"	Y: 1' 8,4"	Z: 11,82"	X: 2' 3,17"	Y: 9,85"	Z: 11,82"
Liferaft Net Weight	37 kg / 82 pounds			30 kg / 67 pounds		
Max. height stowage	10 m / 33'			10 m / 33'		
Painter line length	20 m / 66'					
Inflation Cylinder	1 x 4 litre					

 <b>Crate</b>	X: 830 mm	Y: 540 mm	Z: 330 mm	X: 830 mm	Y: 540 mm	Z: 330 mm
	X: 2' 8,68"	Y: 1' 9,26"	Z: 1' 1"	X: 2' 8,68"	Y: 1' 9,26"	Z: 1' 1"
	39 kg / 86 pounds			32 kg / 71 pounds		
	0,148 m3 / 5,23 cubic foot			0,148 m3 / 5,23 cubic foot		

<b>Towing force</b>	<b>2 knots</b>	<b>3 knots</b>
Without sea anchor	35 daN	60 daN
With sea anchor	48 daN	90 daN

<b>Approvals:</b>	<b>USCG</b>
-------------------	-------------

04 COASTAL USCG LPC 24012012 KLT.doc	Issue: 3	Date: 24/01/2012
--------------------------------------	----------	------------------

Dimensions and weight +/- 5%  
 SURVITEC SAS reserves the right to change specification without notice.  
 For installation, add minimum +10mm for clearance to dimensions of the container.