

06 PERSON COASTAL LIFERAFT - USCG GRP LOW PROFILE CONTAINER & VALISE

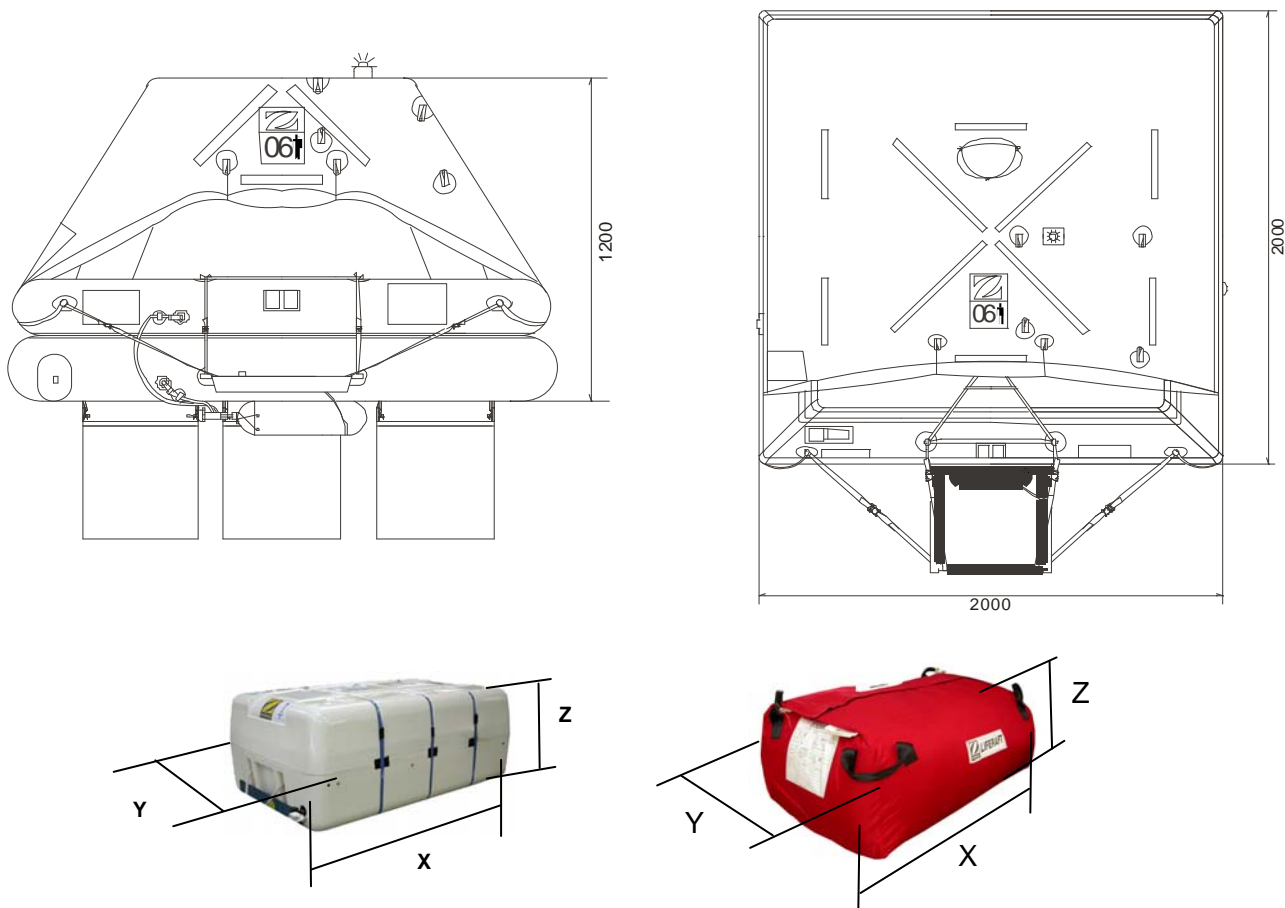
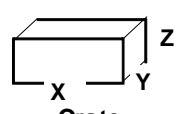

6 MAN	GRP container			Valise		
Container	N131			N° 4		
Dimensions	X: 800 mm	Y: 518 mm	Z: 300 mm	X: 850 mm	Y: 325 mm	Z: 350 mm
	X: 2' 7,5"	Y: 1' 8,4"	Z: 11,82"	X: 2' 9,47"	Y: 1' 0,8"	Z: 1' 1,78"
Liferaft Net Weight	38 kg / 84 pounds			32 kg / 71 pounds		
Max. height stowage	10 m / 33'			10 m / 33'		
Painter line length	20 m / 66'					
Inflation Cylinder	1 x 4 litre					
 Crate	X: 830 mm	Y: 540 mm	Z: 330 mm	X: 930 mm	Y: 540 mm	Z: 350 mm
	X: 2' 8,68"	Y: 1' 9,26"	Z: 1' 1"	X: 3' 0,62"	Y: 1' 9,26"	Z: 1' 1,78"
	40 kg / 89 pounds			34 kg / 75 pounds		
	0,148 m ³ / 5,23 cubic foot			0,176 m ³ / 6,21 cubic foot		
Towing force	2 knots			3 knots		
Without sea anchor	35 daN			60 daN		
With sea anchor	48 daN			90 daN		

Approvals:	USCG
-------------------	-------------

06 COASTAL USCG LPC 24012012 KLT.doc	Issue: 3	Date: 24/01/2012
--------------------------------------	----------	------------------

Dimensions and weight +/- 5%
 SURVITEC SAS reserves the right to change specification without notice.
 For installation, add minimum +10mm for clearance to dimensions of the container.